

# RHG15-90KIT- 1.5" Secondary Rail 90° Elbow with Joiner Kit INSTALLATION

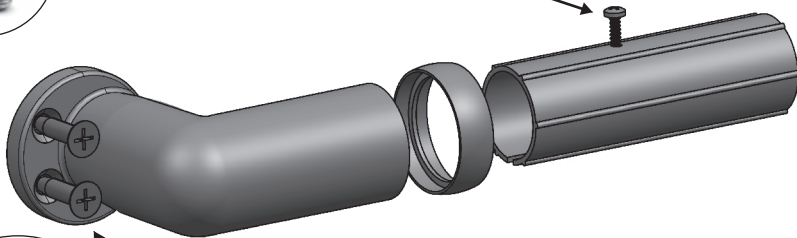

#8 x 1" Phillips Head TEK Screw hold Joiner from sliding inside pipe.



Pre-drill holes with a 13/64" drill bit and put Type F screw in ADA post.



Screw head -  
#3 Phillips